

FurnFold Folding Door System

Drilling and assembly instructions, please follow guide.

Overlay Doors [Drilling detail for overlay doors]

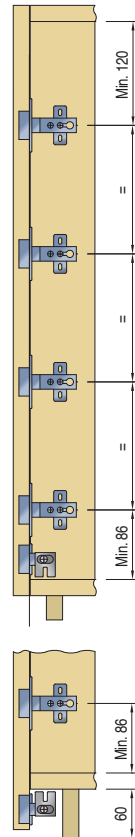
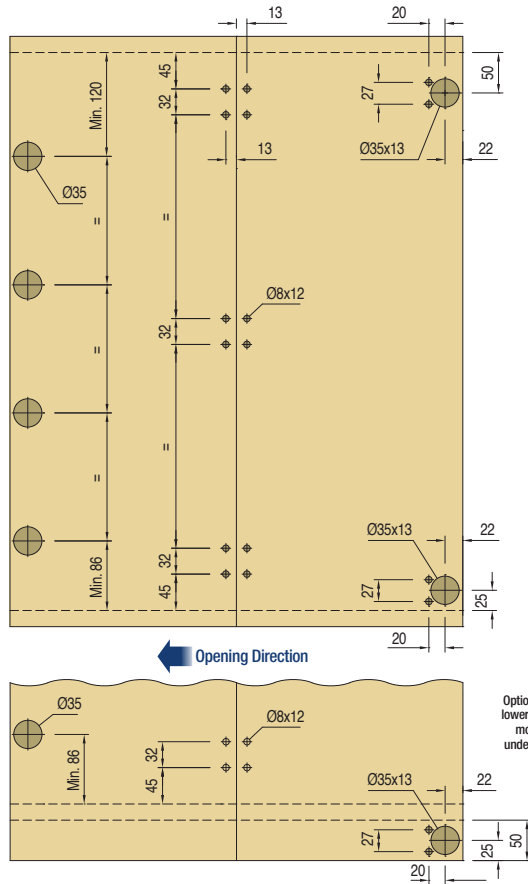

- Weight of door is taken by side hinges and the top roller acts as a guide.
- Refer to hinge capacity to calculate number of hinges required.

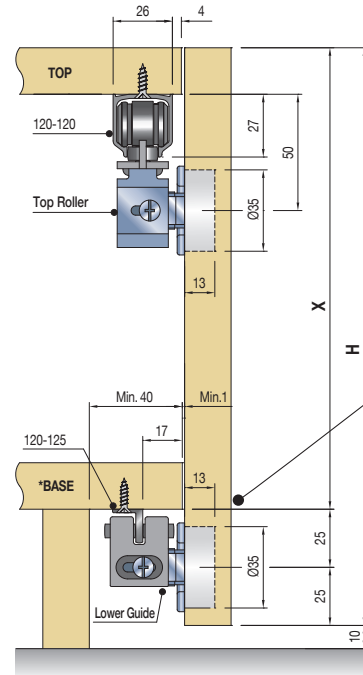

Alternative Bottom Guide Set Up

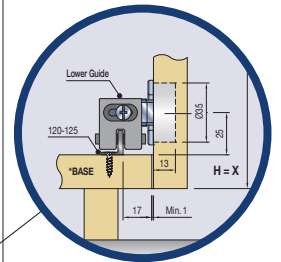

*Can also be fitted on underside of midshelf rather than base if required.

Inframe Doors [Drilling detail for inframe doors]

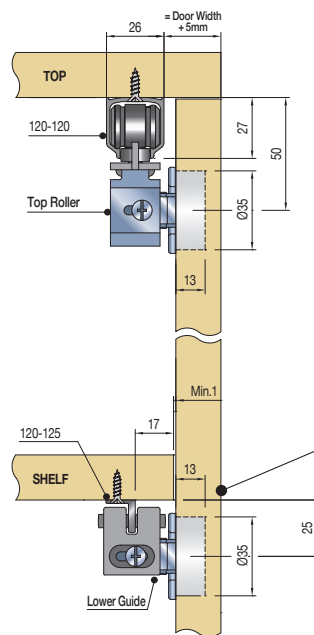
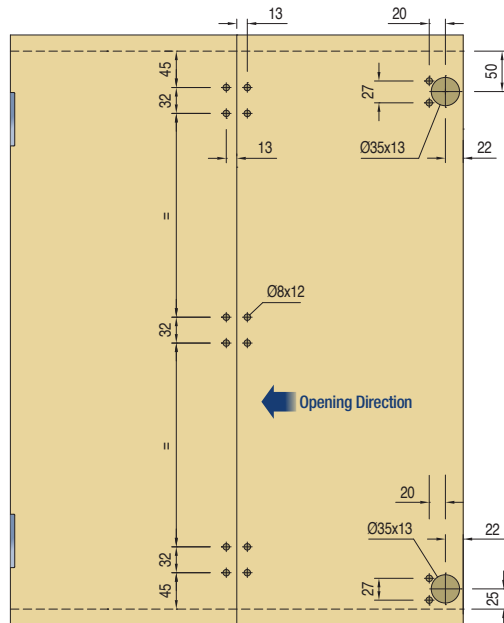

Alternative Bottom Guide Set Up

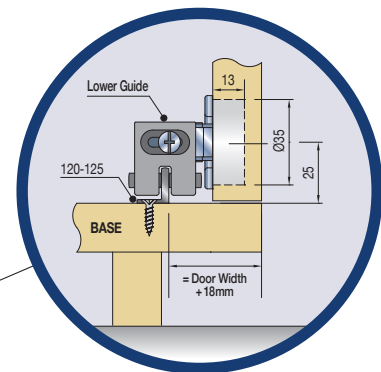

FurnFold Folding Door System

Drilling and assembly instructions, please follow guide.

Centre Hinge Positioning

- Overlay Doors on 110° Hinges
- Inset Doors on Butt Hinges

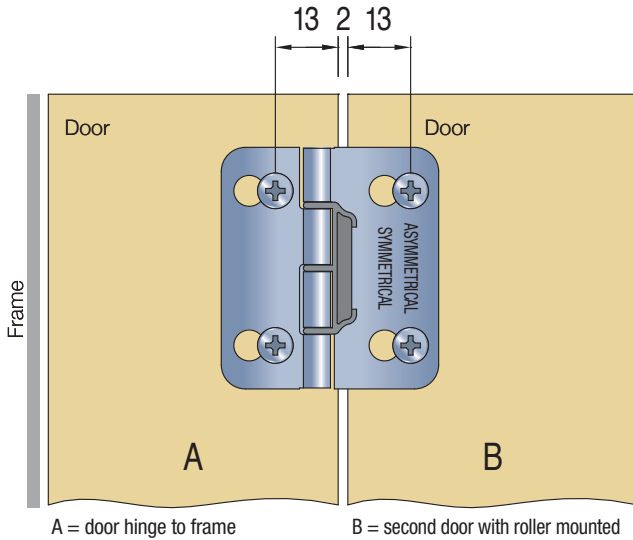

- For Overlay Doors on 90° Hinges

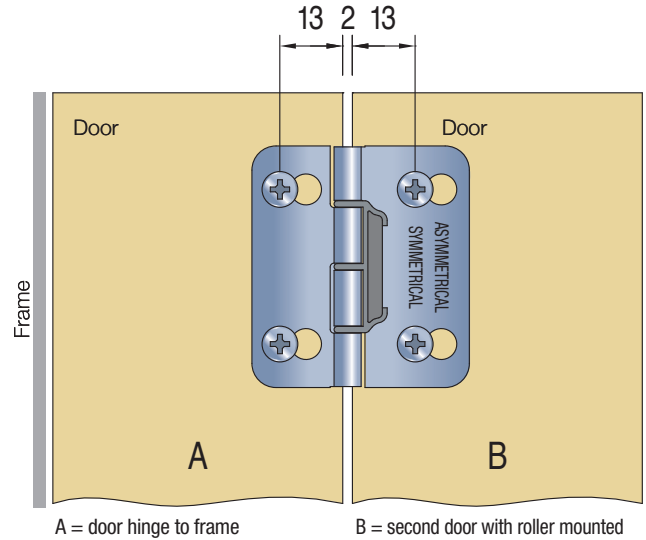

Top Roller Assembly

Install top roller in track prior to fitting track. Fit hinge section to door, hang door and connect to roller as shown.

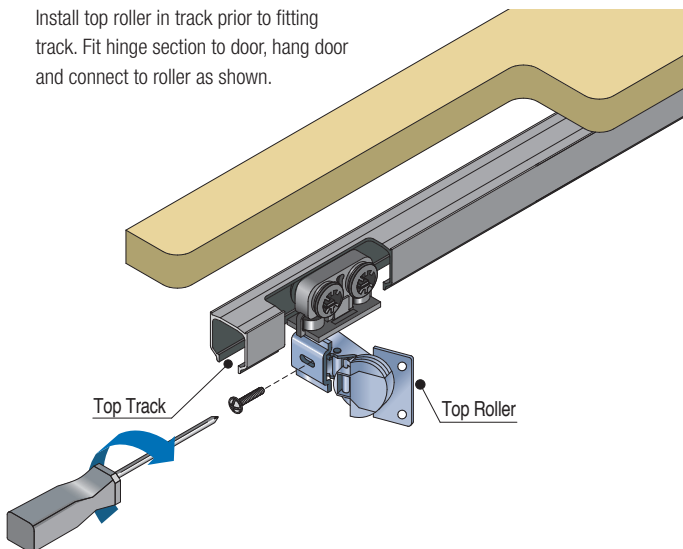

Lower Guide

Fit lower guide profile to base of unit or shelf. Fit hinge section to door. Place guide over guide rail and connect hinge to guide as shown.

